

Acrison®

Model 105Z Volumetric Feeder with Optional Hoppers

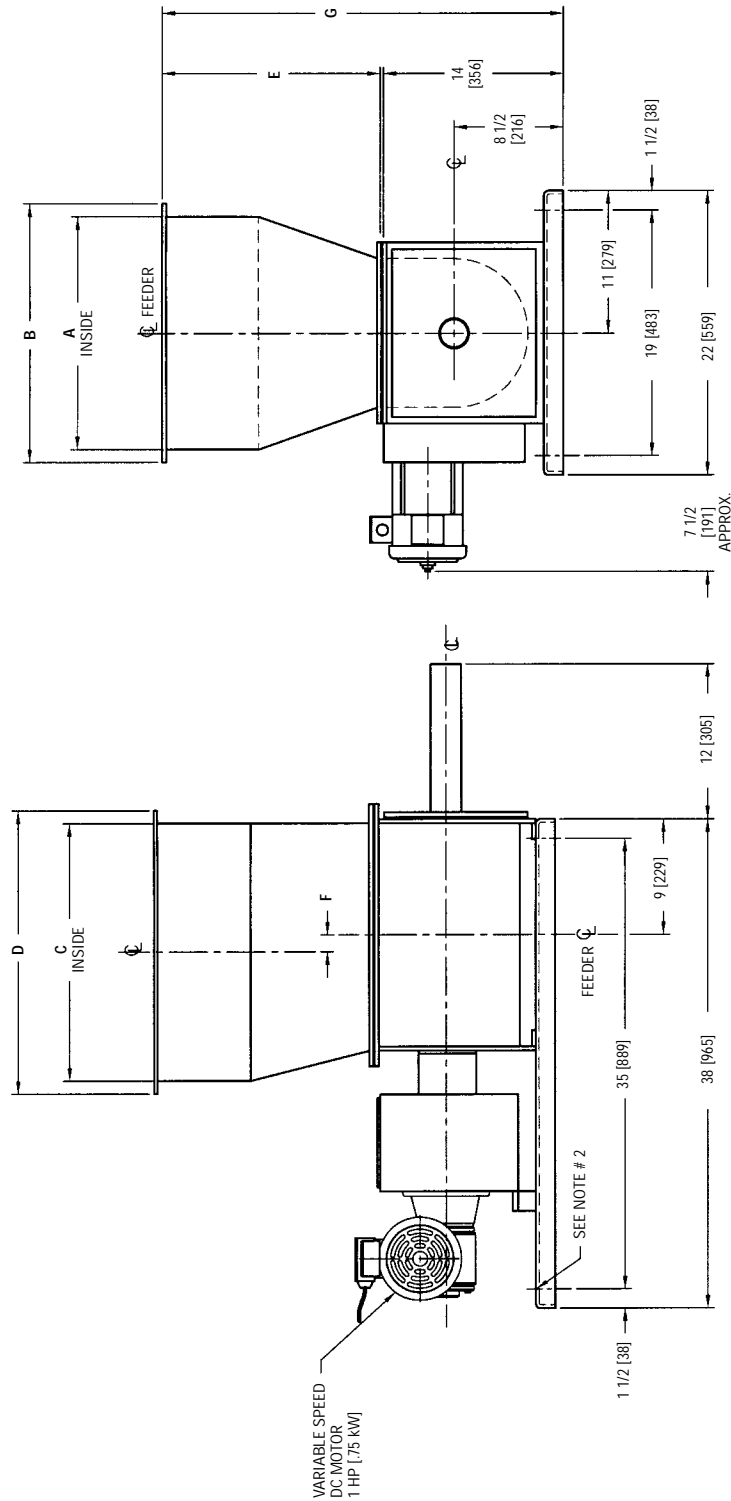

All dimensions are in inches [mm] and subject to change.

NOTES:

- 1 - CONTROLS FURNISHED BY ACRISON, SHIPPED SEPARATELY.
- 2 - (4) 1/2 [13mm] DIAMETER HOLES FOR SECURING.
- 3 - DO NOT SCALE DRAWING.

HOPPER CAPACITY CF [liters] (USABLE)	"A"	"B"	"C"	"D"	"E"	"F"	"G"	WEIGHT (APPROX.) LBS. [kg.]
2 [57]	18 [457]	20 [508]	20 [508]	22 [559]	12 [305]	1 5/16 [33]	26 1/4 [667]	350 [159]
3 [85]	18 [457]	20 [508]	20 [508]	22 [559]	17 [432]	1 5/16 [33]	31 1/4 [794]	375 [170]
4 [113]	20 [508]	22 [559]	24 [610]	26 [660]	18 5/8 [473]	3 5/16 [84]	32 7/8 [835]	400 [181]
6 [170]	20 [508]	22 [559]	24 [610]	26 [660]	29 3/4 [756]	3 5/16 [84]	44 [1118]	425 [193]
8 [227]	20 [508]	22 [559]	24 [610]	26 [660]	38 1/2 [978]	3 5/16 [84]	52 3/4 [1340]	450 [204]

